

**MECHANICAL
SUPPORT
SYSTEMS**

Expectations delivered.



Supports, Fasteners & Consumables

PRODUCT CATALOGUE

Who we are



Founded in 2005 by Directors Hayden Froggatt and John Almond, MSS Ltd is an innovative and forward thinking company, supplying and installing cable containment systems to the electrical and mechanical sectors.

Experience, sound product knowledge and practised efficiency means MSS can provide you with the best and most cost effective solution for your needs.

MSS is accredited under the ISO 9001 for quality management systems and ISO 18001 for safety management systems.

What we do

Cable Ladder/Cable Tray/Cable Basket/Metal Framing Systems/Solid Trunking and Skirting
Duct Systems/Pipe Supports/Seismic Design and Supply/Installation/Bespoke Fabrication

Why MSS

We are specialists in:

Cable & Pipe Support System

Mechanical & Electrical Installations

Design/Engineering/Supply/Installation

Specialised Mechanical Installations

Skirting & Power Duct Interior Fitouts

Special Fabrication and Engineering

We can design, engineer, manufacture and install to your specifications providing you with quality products, on time and within budget.

General and Bespoke Fabrication

Our main focus is on light to medium steel fabrication, with an emphasis on small production runs and one-off high end bespoke works.

Our scope and skill set is broad due to a wide range of the latest technology available in-house including the latest in automated plant and equipment. We regularly update our capital equipment to ensure jobs are executed to the highest standard, on time and within budget.

Our highly trained team of Designers, Fabricators and Welders pride themselves on delivering precision design and engineering in Aluminium, Steel and Stainless Steel.

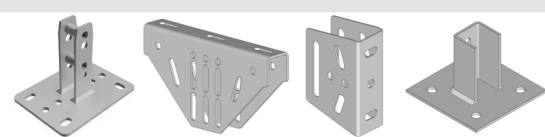

Solid Hanger Brackets:

| | |
|--|------|
|  | Page |
| Introducing the Clip In Bracket System | 1 |
| EM/CFB Bracket For ComFlor® | 2 |
| EM/WNM10 Wedge Nut For ComFlor® | 2 |
| VK/SMB/HMB Horizontal Mounting Bracket | 2 |
| VK/SMB/VMB Vertical Mounting Bracket | 3 |
| EM2072B Traditional Mounting Bracket | 3 |

CLB Clip-In Bracket System:

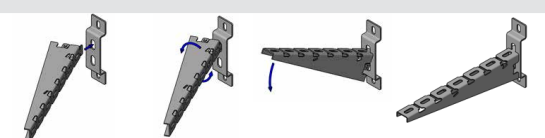
| | |
|--|------|
|  | Page |
| Introducing the Clip In Bracket System | 5 |
| VK/CLB Clip In Bracket | 6 |
| VK/CLB Bracket Rear Plate | 6 |
| VK/SMB3 Slotted 3-Way Channel Hanger | 7 |
| EM1000T3 3-Way Slotted Channel | 7 |

Trapeze Support Materials:

| | |
|----------------------|------|
| | Page |
| MSS Trapeze Kit | 8 |
| Threaded Rod Hangers | 10 |
| Socket Drivers | 11 |
| Threaded Rod | 12 |
| Rod Accessories | 12 |
| Bolts and Screws | 13 |
| Concrete Anchors | 13 |
| Nuts | 14 |
| Washers | 14 |

Cantilever Brackets and Miscellaneous Supports:

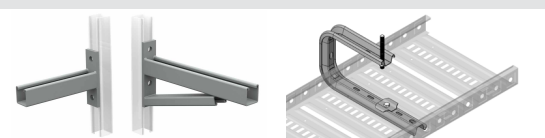
| | |
|--|------|
|  | Page |
| Cantilever Brackets | 16 |
| Cantilever Brackets continued | 17 |
| Cable Mesh Hangers | 18 |
| Cable Mesh Hangers continued | 19 |
| VK/THB Single Hanger Bracket | 20 |
| VK/WHB Wall Mounted Hanger Bracket | 20 |
| VK/FS PG Wall and Floor Stand | 21 |

General Fasteners and Accessories

| | |
|--|------|
|  | Page |
| Wire and Accessories | 21 |
| KBV Fast Locking Clip for Cable Tray / Trunking | 22 |
| EMT Flanged Bolt and Nut for Cable Tray / Ladder | 22 |
| Rod, Bolt and Mesh Cutting Tools | 22 |
| Cutting and Grinding Discs | 22 |
| Finishing Sprays | 22 |
| | |
| | |
| | |
| | |

Product Catalogue Range

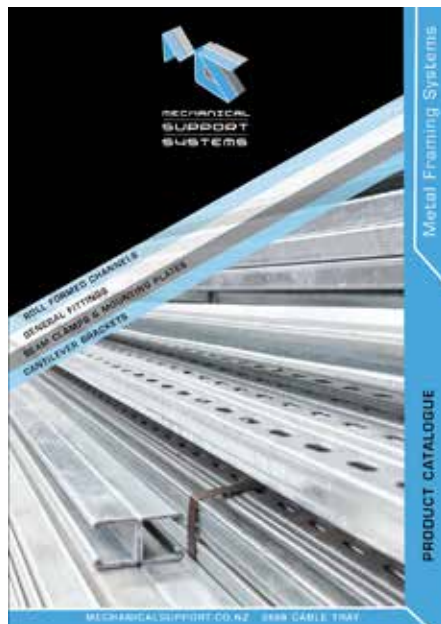
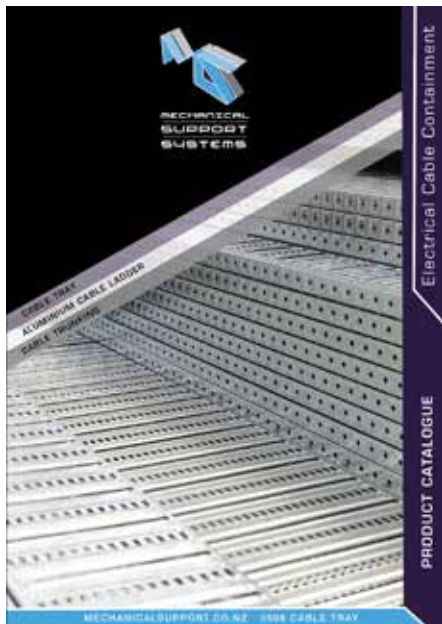

Download a catalogue www.mechanicalsupport.co.nz

Get in touch with us 0508 CABLE TRAY or (09) 279-8292



CERTIFIED QUALITY SYSTEM – ISO 9001:2015
BS OHSAS 18001 : 2007 & AS/NZS 4801:2001
PAS99 : 2012



SOLID HANGER BRACKETS

Simple and Versatile Single Drop System

Solid Hanger Bracket System Advantages:

- Use with the **CLB Clip In Bracket System** (see next section for details)
- Single Central Dropper allows for **easy installation and removal of cables**
- Hang from **angled faces**, such as purlins or sloping ceilings
- **Span gaps in the ceiling face** (such as Comflor® flooring/ceilings) with flexible hanging positions
- Can be utilised to secure **seismic bracing**

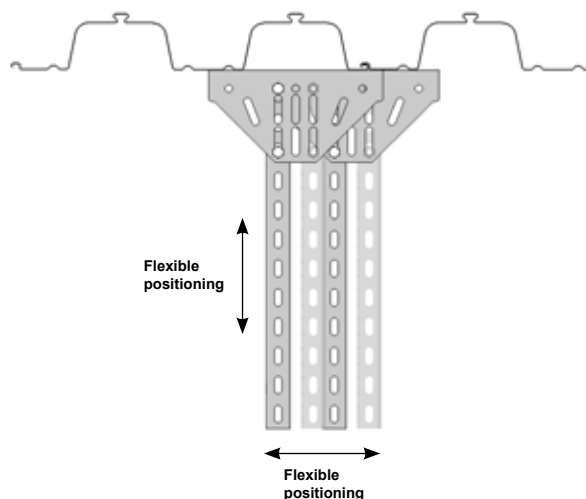
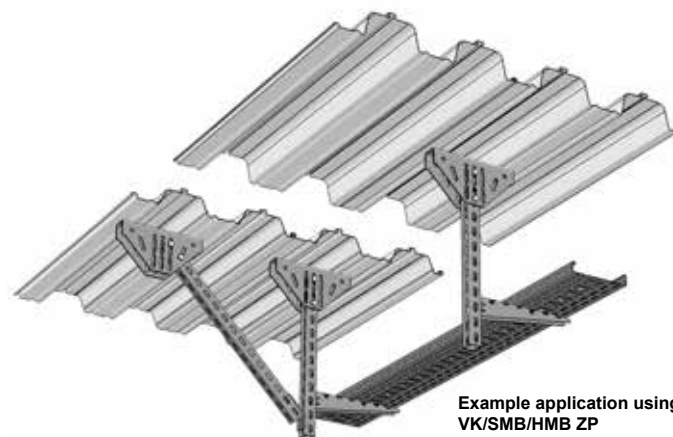
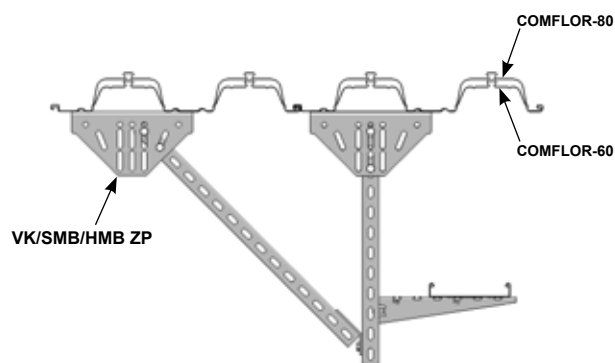
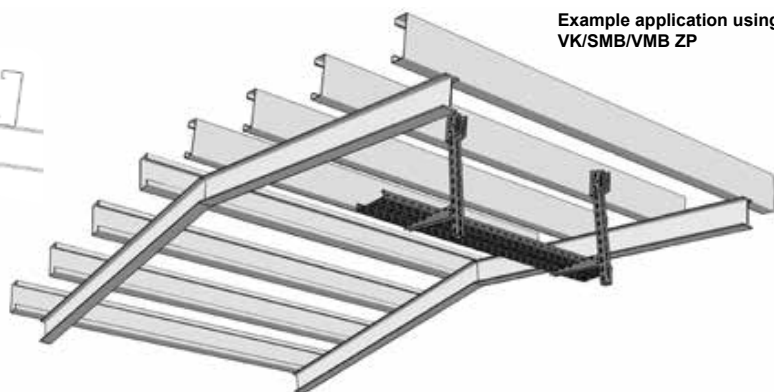
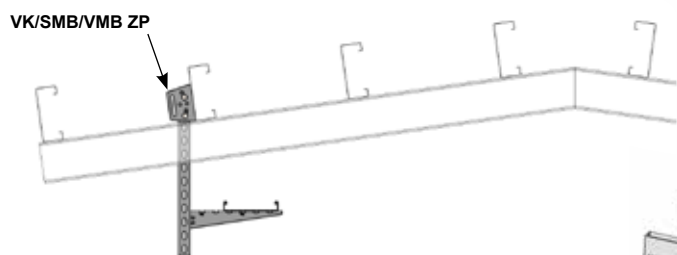

Example positioning using VK/SMB/HMB ZP

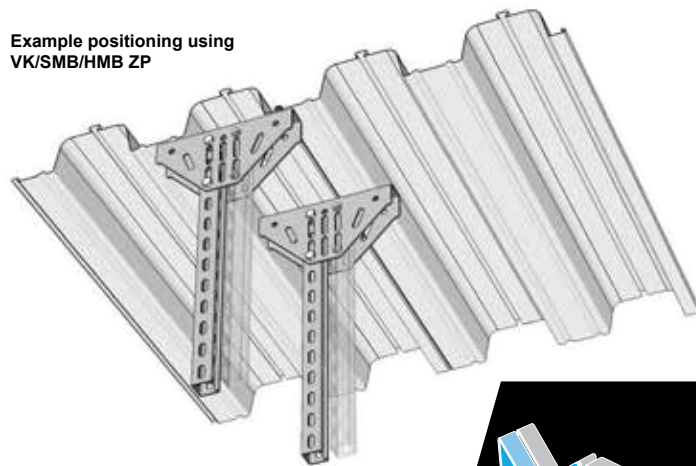

CERTIFIED QUALITY SYSTEM – ISO 9001:2015
BS OHSAS 18001 : 2007 & AS/NZS 4801:2001
PAS99 : 2012



MECHANICAL
SUPPORT
SYSTEMS
Expectations
delivered.

SOLID HANGER BRACKETS

EM/CFB BRACKET for ComFlor®

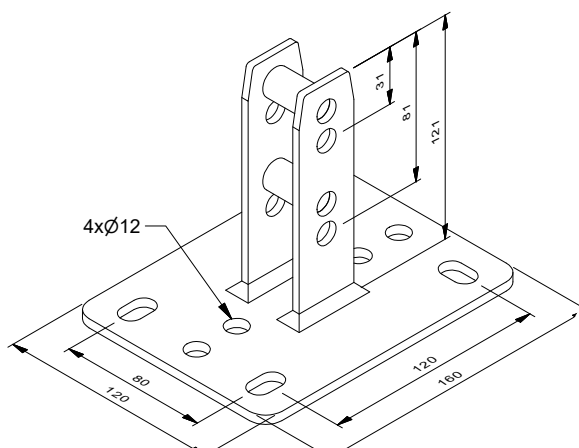

Standard Finish: Zinc Plated

Part Number:

EM/CFB Bracket ZP

EM/WNM10 Wedge Nut for ComFlor®

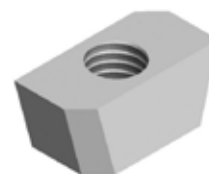
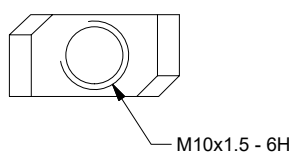

Standard Finish: Zinc Plated

Part Number:

EM/WNM 10 60 ZP

EM/WNM 10 80 ZP

VK/SMB/HMB Horizontal Mounting Bracket

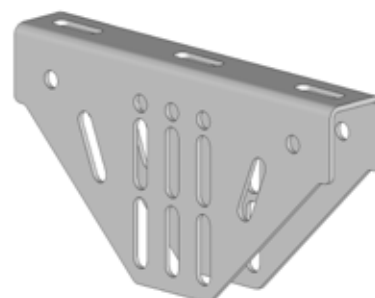
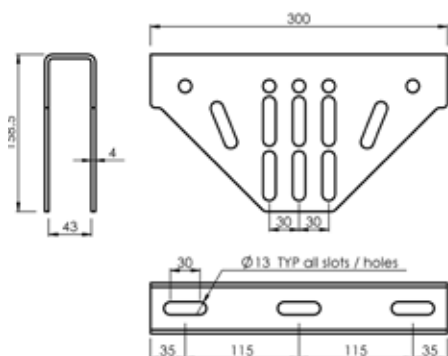

Standard Finish: Zinc Plated

Part Number:

VK/SMB/HMB ZP

See application examples on the previous page.

CERTIFIED QUALITY SYSTEM – ISO 9001:2015
BS OHSAS 18001 : 2007 & AS/NZS 4801:2001
PAS99 : 2012

SOLID HANGER BRACKETS

VK/SMB/VMB Vertical Mounting Bracket

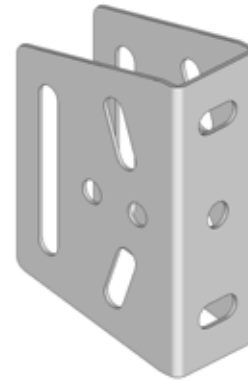
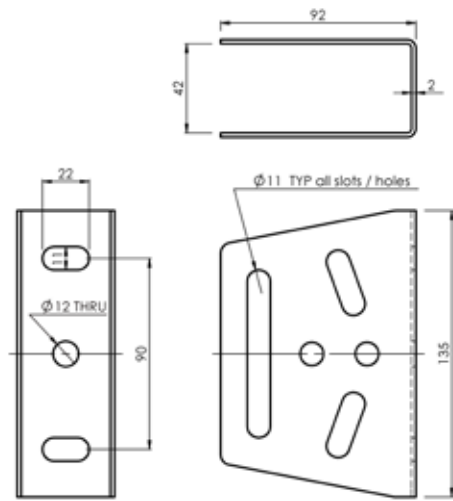

Standard Finish: Zinc Plated

Part Number:

VK/SMB/VMB ZP

See application examples on the previous page.

EM2072B Traditional Mounting Bracket

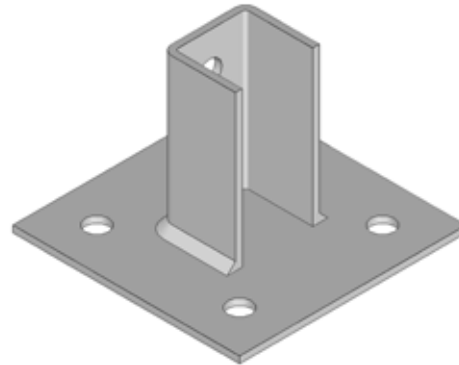
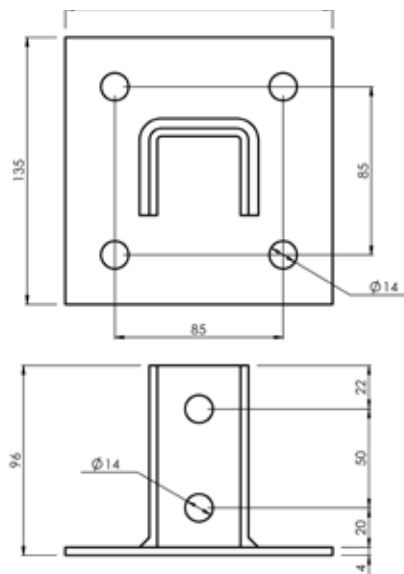

Standard Finish: Hot Dip Galvanised

Part Number:

EM2072B



CERTIFIED QUALITY SYSTEM – ISO 9001:2015
BS OHSAS 18001 : 2007 & AS/NZS 4801:2001
PAS99 : 2012



© Mechanical Support Systems. Mechanical Support Systems reserves the right to change designs and specifications without notice.



MECHANICAL
SUPPORT
SYSTEMS
Expectations
delivered.

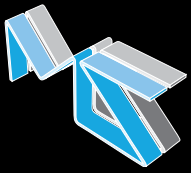

**MECHANICAL
SUPPORT
SYSTEMS**

Expectations
delivered.



**SOLID HANGER BRACKET AND CLB SYSTEM INSTALLATION BY MSS
NEW ZEALAND INTERNATIONAL CONVENTION CENTRE 2017**



CLB CLIP IN BRACKET SYSTEM

Fast, Easy, Efficient

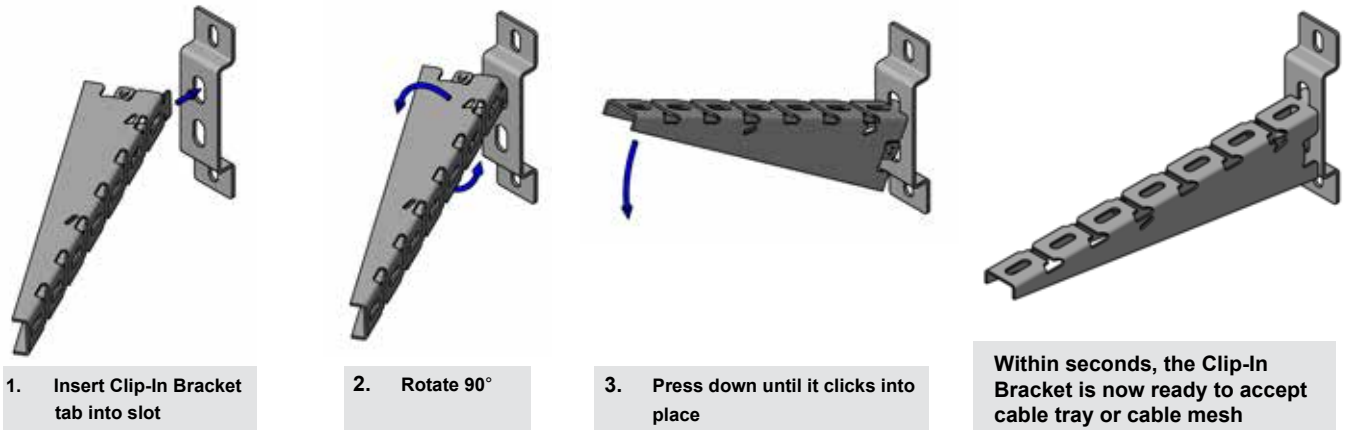

CLB System Advantages

- **Labour Saving** - no nuts, bolts or cutting required, simply click to lock in place
- **Side Loading** in all applications for ease of cable installation & access
- **Seismically Compliant in many applications** (ask us about our seismic design & documentation options)
- **Galvanised Finish** suited for most internal and external applications
- No need for trapeze supports of multiple tiers
- Cable Mesh simply **locks into place** without the need for fasteners
- **Compatible with MSS Light & Medium Duty Cable Tray and Cable Mesh**

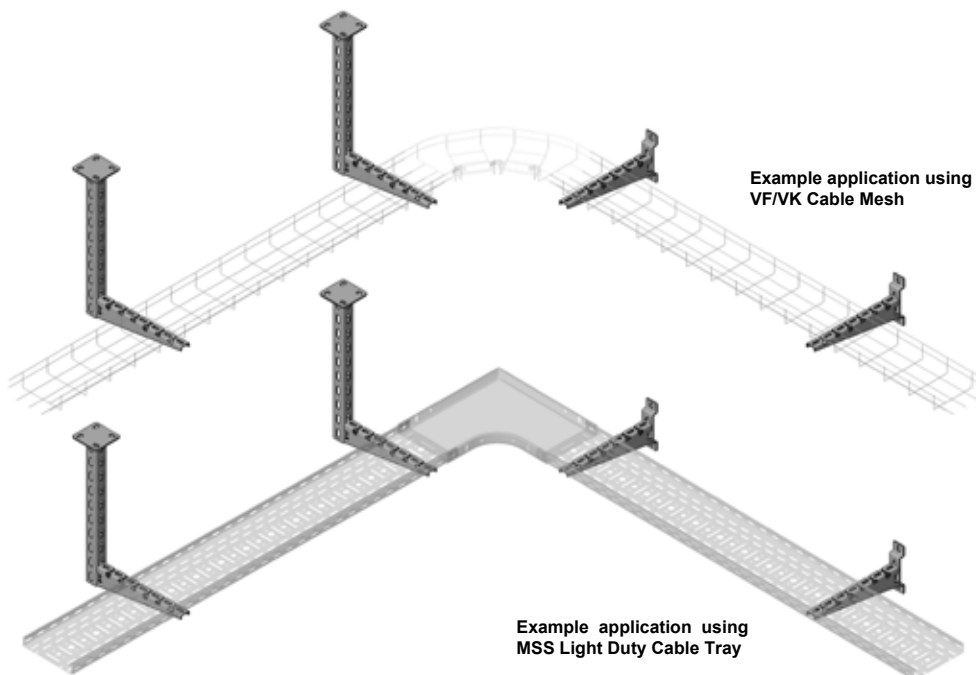

CERTIFIED QUALITY SYSTEM – ISO 9001:2015
BS OHSAS 18001 : 2007 & AS/NZS 4801:2001
PAS99 : 2012



© Mechanical Support Systems. Mechanical Support Systems reserves the right to change designs and specifications without notice.



MECHANICAL
SUPPORT
SYSTEMS
Expectations
delivered.

CLIP IN BRACKET SYSTEM

VK/CLB Clip-In Bracket

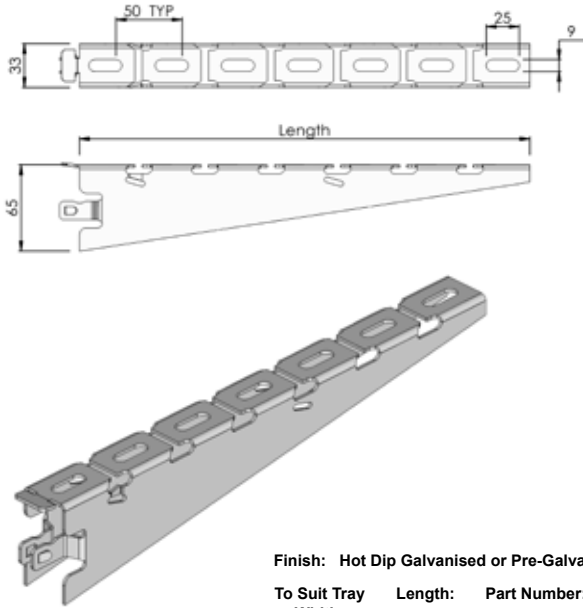

Finish: Hot Dip Galvanised or Pre-Galvanised

To Suit Tray Width: Length: Part Number:

| | | |
|-----|-----|-----------|
| 150 | 190 | VK/CLB150 |
| 200 | 240 | VK/CLB200 |
| 300 | 340 | VK/CLB300 |
| 400 | 440 | VK/CLB400 |
| 500 | 540 | VK/CLB500 |

Load Capacity* of KBSI/CLB HDG Clip-In Bracket + KBSI/SMB3/1000 HDG Slotted 3-Way Channel Hanger

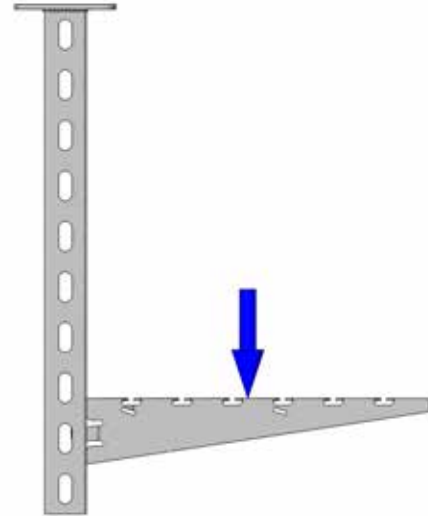

KBSI/CLB Size: Load Capacity (kg):

| | |
|-----|-----|
| 190 | 190 |
| 240 | 120 |
| 340 | 85 |
| 440 | 60 |
| 540 | 40 |

*Load data is provided as a basic guide - for more specific load data please contact MSS

VK/CLB Bracket Rear Plate

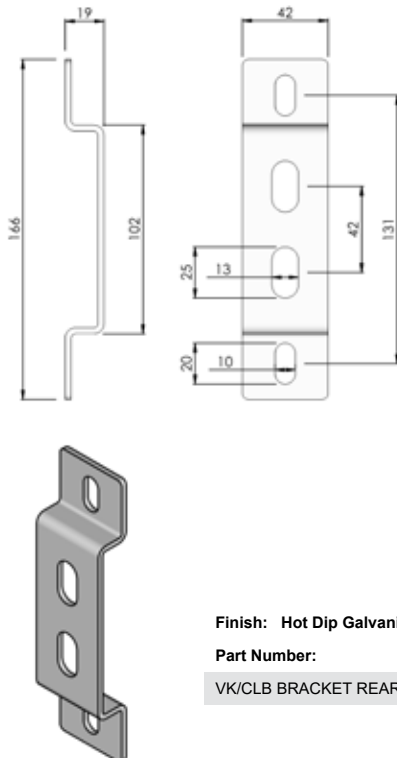

Finish: Hot Dip Galvanised or Pre-Galvanised

Part Number:

VK/CLB BRACKET REAR PLATE

Load Capacity* of KBSI/CLB HDG Clip-In Bracket + KBSI/CLB Bracket Rear Plate

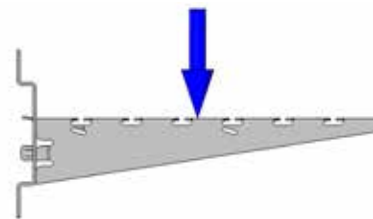

KBSI/CLB Size: Load Capacity (kg):

| | |
|-----|-----|
| 190 | 190 |
| 240 | 160 |
| 340 | 125 |
| 440 | 90 |
| 540 | 70 |

*Load data is provided as a basic guide - for more specific load data please contact MSS

CERTIFIED QUALITY SYSTEM – ISO 9001:2015
BS OHSAS 18001 : 2007 & AS/NZS 4801:2001
PAS99 : 2012

CLIP IN BRACKET SYSTEM

VK/SMB3 Slotted 3-Way Channel Hanger

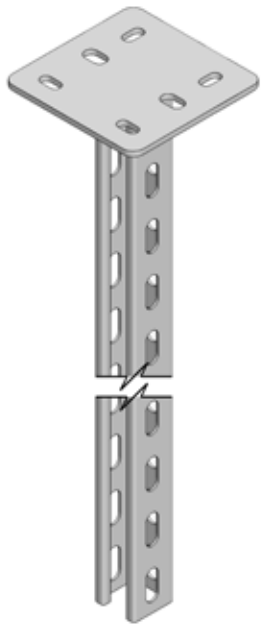

Predetermined length of EM1000T3
Channel with welded base plate

Finish: Pre-Galvanised 600,1000,1200
Hot Dip Galvanised 1200

Part Number:

VK/SMB3/600

VK/SMB3/1000 PG

VK/SMB3/1200 PG

VK/SMB3/1000 HDG

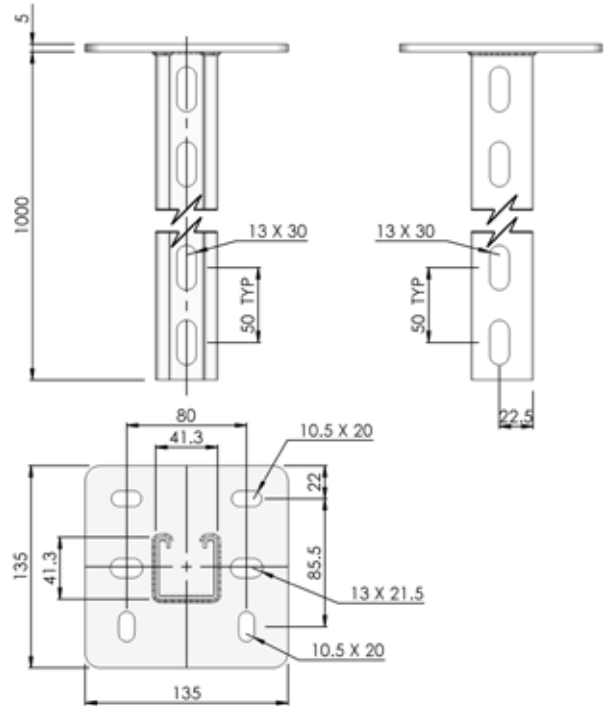

EM1000T3 3-Way slotted Channel

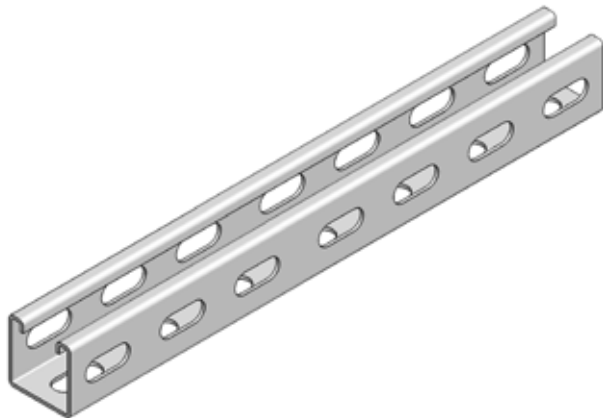
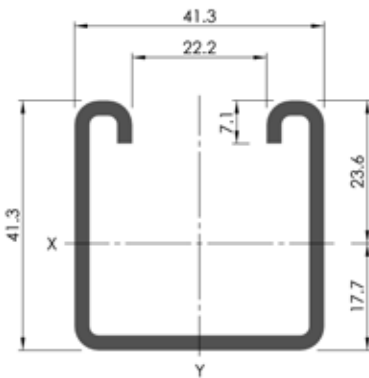

EM1000T

Weight:

2.32kg/m

Thickness:

2.5mm

Material:

250MPa (minimum yield stress) mild steel

Finishes:

Plain, Pre-Galvanised, Hot Dip Galvanised, Electro Powder Coated, 316 GR Stainless Steel
(other finishes available on request)



CERTIFIED QUALITY SYSTEM – ISO 9001:2015
BS OHSAS 18001 : 2007 & AS/NZS 4801:2001
PAS99 : 2012



© Mechanical Support Systems. Mechanical Support Systems reserves the right to change designs and specifications without notice.

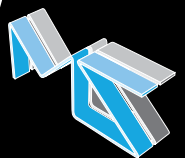

MECHANICAL
SUPPORT
SYSTEMS
Expectations
delivered.

MSS TRAPEZE KIT COMPONENT BREAKDOWN

When quoting projects MSS can offer 'Trapeze Kits' for ease of pricing, each Trapeze Kit contains the required amount of EM2000 Channel plus the following accessories to construct one trapeze.

Note: Trapeze Kits are quoted using Internal Hold Down Washers [see Detail A] - External Hold Down Brackets can be supplied at an additional cost, please specify requirements when asking for a quote.

DETAIL A (x 2)

HHSSM08X20
Hex Head Screw

EMT/HDW Hold
Down Washer

EM/SNLM08
Spring Nut

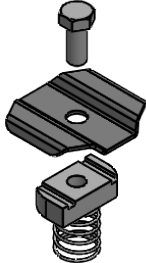

DETAIL B (x 2)

HNM10 Hex Nut

FWSQM10 Square Washer

EM/SNLM08 Spring Nut

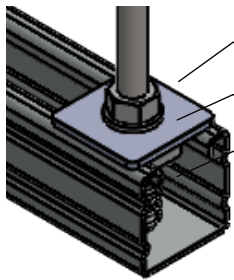

DETAIL C (x 2) (Option 1)

RH-MSSM10X25

HNM10 Hex Nut

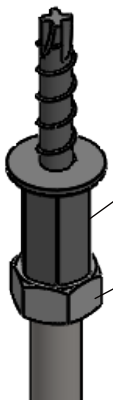

DETAIL D (x 2) (Option 2)

HNM10 Hex Nut

RH/MSSM10x25/SHSTEEL

HNM10 Hex Nut

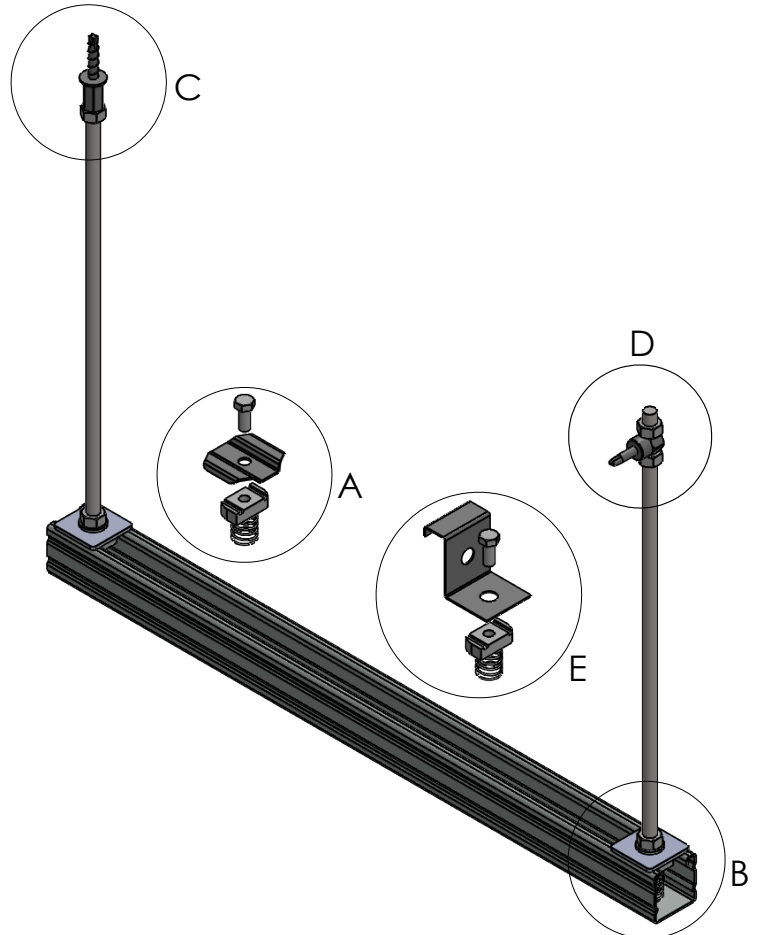
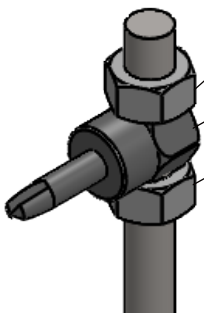

DETAIL E (x 2) (available on request)

HHSSM08X20 Hex Head Screw

EMT3-HDB Hold Down Bracket

EM-SNLM08 Spring Nut

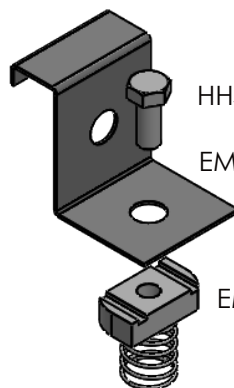

CERTIFIED QUALITY SYSTEM – ISO 9001:2015
BS OHSAS 18001 : 2007 & AS/NZS 4801:2001
PAS99 : 2012

TRAPEZE SUPPORT SYSTEM

Traditional Hanging Materials

Trapeze System Advantages



CERTIFIED QUALITY SYSTEM – ISO 9001:2015
BS OHSAS 18001 : 2007 & AS/NZS 4801:2001
PAS99 : 2012



© Mechanical Support Systems. Mechanical Support Systems reserves the right to change designs and specifications without notice.



**MECHANICAL
SUPPORT
SYSTEMS**
Expectations
delivered.

THREADED ROD HANGERS

RH/MSSM10X25/STEEL Rod Hanger

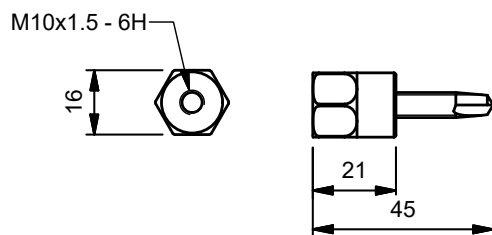
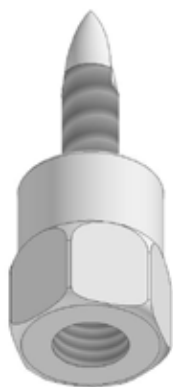

RH/MSSM10X25/STEEL
Mass: 2.5KG/100
Finish: ZP

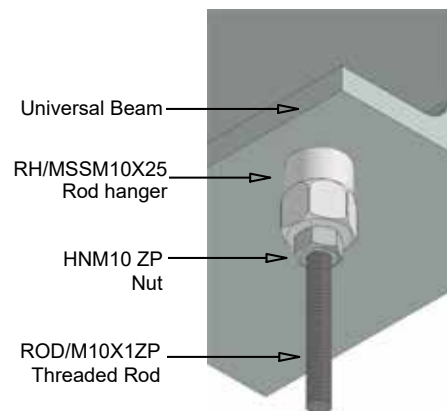

RH/MSSM10X25/SHSTEEL Side Entry Rod Hanger

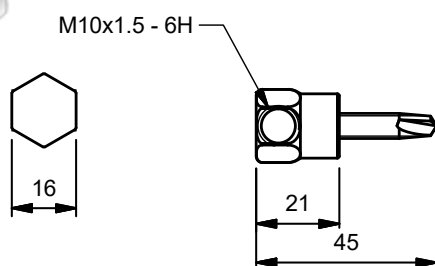
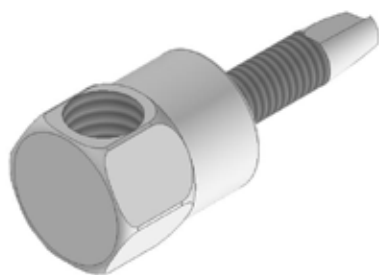

RH/MSSM10X25/SHSTEEL
Mass: 2.5KG/100
Finish: ZP

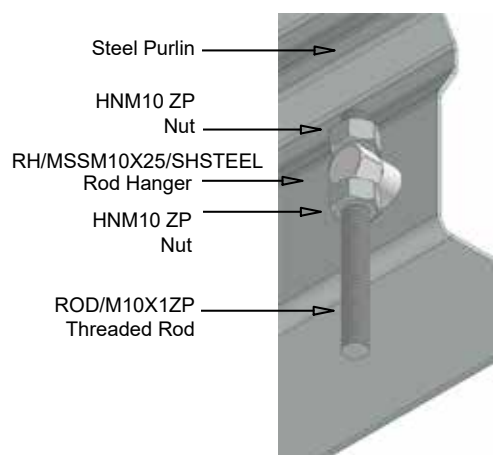

RH/MSSM10X35/CONCRETE Rod Hanger

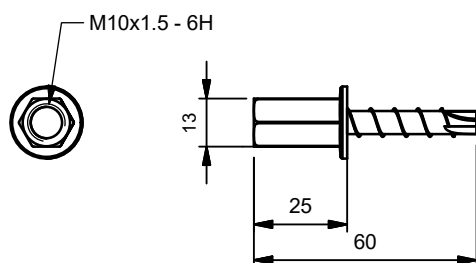
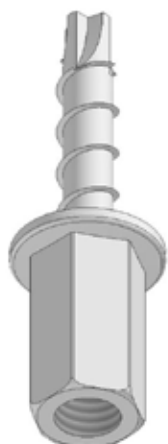

RH/MSSM10X35/CONCRETE
Use Ø6mm Concrete drill
Mass: 2.5KG/100
Finish: ZP

RH/MSSM10X35/CONCRETE
Rod hanger
HNM10 ZP
Nut
ROD/M10X1ZP
Threaded Rod

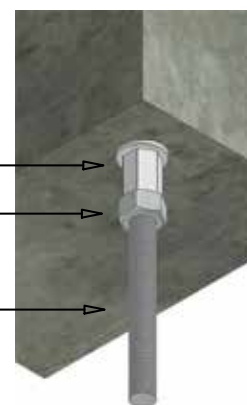

CERTIFIED QUALITY SYSTEM – ISO 9001:2015
BS OHSAS 18001 : 2007 & AS/NZS 4801:2001
PAS99 : 2012

THREADED ROD HANGERS

RH/MSSM10X25/WOOD Rod Hanger

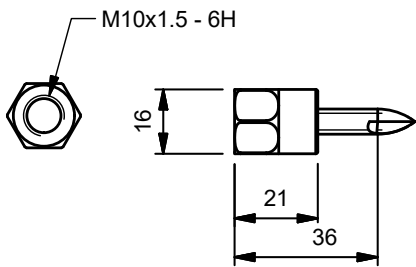
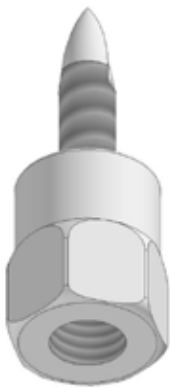

RH/MSSM10X25/WOOD
Mass: 2.5KG/100
Finish: ZP
Also available RH/MSSM10X50/WOOD

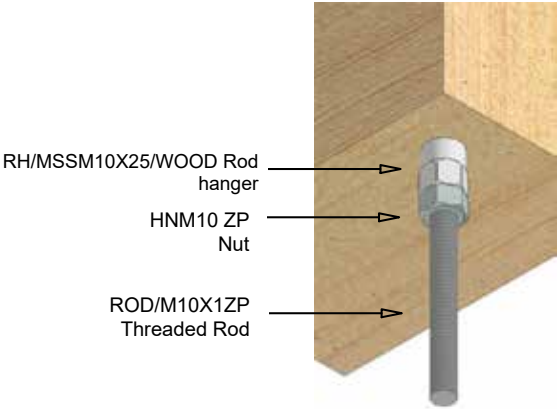

CERTIFIED QUALITY SYSTEM – ISO 9001:2015
BS OHSAS 18001 : 2007 & AS/NZS 4801:2001
PAS99 : 2012

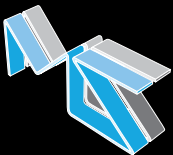

THREADED ROD AND ACCESSORIES

Threaded Rod

| Product Code: | Size: | Length: | Finish: |
|---------------|-------|---------|--------------|
| ROD/M06X1 ZP | M6 | 1 metre | Zinc Plated |
| ROD/M08X1 ZP | M8 | 1 metre | Zinc Plated |
| ROD/M10X1 ZP | M10 | 1 metre | Zinc Plated |
| ROD/M12X1 ZP | M12 | 1 metre | Zinc Plated |
| ROD/M16X1 ZP | M16 | 1 metre | Zinc Plated |
| ROD/M20X1 ZP | M20 | 1 metre | Zinc Plated |
| ROD/M10X1 HDG | M10 | 1 metre | Hot Dip Galv |
| ROD/M12X1 HDG | M12 | 1 metre | Hot Dip Galv |
| ROD/M16X1 HDG | M16 | 1 metre | Hot Dip Galv |
| ROD/M20X1 HDG | M20 | 1 metre | Hot Dip Galv |
| ROD/M06X2 ZP | M6 | 2 metre | Zinc Plated |
| ROD/M08X2 ZP | M8 | 2 metre | Zinc Plated |
| ROD/M10X2 ZP | M10 | 2 metre | Zinc Plated |
| ROD/M12X2 ZP | M12 | 2 metre | Zinc Plated |
| ROD/M16X2 ZP | M16 | 2 metre | Zinc Plated |
| ROD/M20X2 ZP | M20 | 2 metre | Zinc Plated |
| ROD/M08X2 HDG | M08 | 2 metre | Hot Dip Galv |
| ROD/M10X2 HDG | M10 | 2 metre | Hot Dip Galv |
| ROD/M12X2 HDG | M12 | 2 metre | Hot Dip Galv |
| ROD/M16X2 HDG | M | 2 metre | Hot Dip Galv |



Rod Accessories

Rod Connector



| Diameter:: | Product Code: | Finish: |
|------------|---------------|----------|
| M6 | RODCONM06 | ZP |
| M8 | RODCONM08 | ZP |
| M10 | RODCONM10 | ZP / HDG |
| M12 | RODCONM12 | ZP / HDG |
| M16 | RODCONM16 | ZP |
| M20 | RODCONM20 | ZP |

Rod Cap



| Diameter: | Product Code: |
|-----------|---------------|
| M10 | Rod Cap Grey |

Rod Stiffeners - Seismic



| Diameter: | Product Code: | Finish: |
|-----------|---------------|---------|
| M10 | RODSTIFM | ZP |

CERTIFIED QUALITY SYSTEM – ISO 9001:2015
BS OHSAS 18001 : 2007 & AS/NZS 4801:2001
PAS99 : 2012

GENERAL FASTENERS

Bolts and Screws

Hex Head Set Screws



| Diameter: | Product Code: | Lengths: (mm) | Finish: |
|-----------|---------------|----------------------------|----------|
| M6 | HHSSM06 | 20, 25, 30, 35, 40, 50 | ZP |
| M8 | HHSSM08 | 20, 25, 30, 35, 40, 60 | ZP / HDG |
| M10 | HHSSM10 | 20, 25, 30, 35, 40, 50, 60 | ZP / HDG |
| M12 | HHSSM12 | 20, 25, 30, 35, 40, 50 | ZP / HDG |
| M16 | HHSSM16 | 30, 35, 40, 50, 70, 80 | ZP / HDG |

Dyna Sets



| Product Code: | Lengths: (mm) | Finish: |
|---------------|----------------------|---------|
| DIAM | 6, 8, 10, 12, 16, 20 | ZP |

Concrete Anchors

Seismic Stud Anchor for Concrete



| Diameter: | Product Code: | Lengths (mm) | Finish: |
|-----------|---------------|--------------|---------|
| M10 | SEA M10 | 90, 100, 110 | HDG |
| M12 | SEA M12 | 115 | ZP |

Sleeve Anchor



| Diameter: | Product Code: | Lengths (mm) | Finish: |
|-----------|---------------|---------------------|----------|
| M6 | SAM06 | 40, 55, 75 | ZP / HDG |
| M8 | SAM08 | 40, 65, 85 | ZP / HDG |
| M10 | SAM10 | 40, 50, 60, 75, 100 | ZP / HDG |
| M12 | SAM12 | 60, 75, 100 | ZP / HDG |



CERTIFIED QUALITY SYSTEM – ISO 9001:2015
BS OHSAS 18001 : 2007 & AS/NZS 4801:2001
PAS99 : 2012



Gutter Bolts



| Diameter: | Product Code: | Lengths: (mm) | Finish: |
|-----------|---------------|----------------|---------|
| M6 | GBM06 | 12, 16, 20, 25 | ZP |
| M6 | GBFM06 | 10 | ZP |

Coach Screws - Wood



| Diameter: | Product Code: | Lengths: (mm) | Finish: |
|-----------|---------------|---------------|---------|
| M8 | CSM08 | 40, 50 | HDG |
| M10 | CSM10 | 40, 50, 100 | HDG |
| M12 | CSM12 | 40, 65, 100 | HDG |

Screw Anchor for Concrete



| Diameter: | Product Code: | Lengths (mm) | Finish: |
|-----------|---------------|--------------|---------|
| M10 | SCA M10 | 75, 80 | ZP |
| M8 | SCA M08 | 55 | S/S |
| M6 | SCA M06 | 35 | ZP |



MECHANICAL
SUPPORT
SYSTEMS
Expectations
delivered.

GENERAL FASTENERS

Nuts

Spring Nuts



Product Code:
EM/SNL (size) (finish)

| Diameter | Finish: |
|----------|-------------------|
| M6 | ZP / HDG |
| M8 | ZP / HDG / SS 316 |
| M10 | ZP / HDG / SS 316 |
| M12 | ZP / HDG / SS 316 |
| M16 | ZP |

Kwik Nut



| Product Code: | Diameter: | Finish: |
|---------------|-----------|---------|
| EM/KWIKNUT | 10 | ZP |

Hex Nuts



| Product Code: | Sizes: | Finish: |
|---------------|--------------------------|----------|
| HNM | 6, 8, 10, 12, 16, 20, 24 | ZP / HDG |

Nylock Hex Nuts



| Product Code: | Metric: | Finish: |
|---------------|---------|---------|
| HN/NYLOCKM | 10 | ZP |

Flanged Hex Nuts



| Product Code: | Metric: | Finish: |
|---------------|----------|----------|
| HNFM | 6, 8, 10 | ZP / HDG |

Washers

Flat Washers



| Product Code: | Sizes: | Finish: |
|---------------|------------------|----------|
| FWSM | 6, 8, 10, 12, 16 | ZP / HDG |

Spring Washers



| Product Code: | Sizes: | Finish: |
|---------------|------------------|----------|
| SWSM | 6, 8, 10, 12, 16 | ZP / HDG |

Square Washer



| Product Code: | Bolt Size: | Hole Size: | Thickness: | Finish: |
|---------------|------------|------------|------------|---------|
| FWSQM | 10 | 12 | 3MM | HDG |
| FWSQM | 12 | 14 | 3MM | HDG |
| EM1062 | 8 | 9 | 6MM | HDG |
| EM1063 | 10 | 12 | 6MM | HDG |
| EM1064 | 12 | 14 | 6MM | HDG |
| EM1964 | 16 | 18 | 6MM | HDG |

Penny Washers



| Product Code: | Sizes: | Finish: |
|---------------|----------|---------|
| PWSM | 6, 8, 10 | ZP |

CERTIFIED QUALITY SYSTEM – ISO 9001:2015
BS OHSAS 18001 : 2007 & AS/NZS 4801:2001
PAS99 : 2012

CANTILEVER BRACKETS AND MISCELLANEOUS SUPPORTS

Traditional Support Brackets

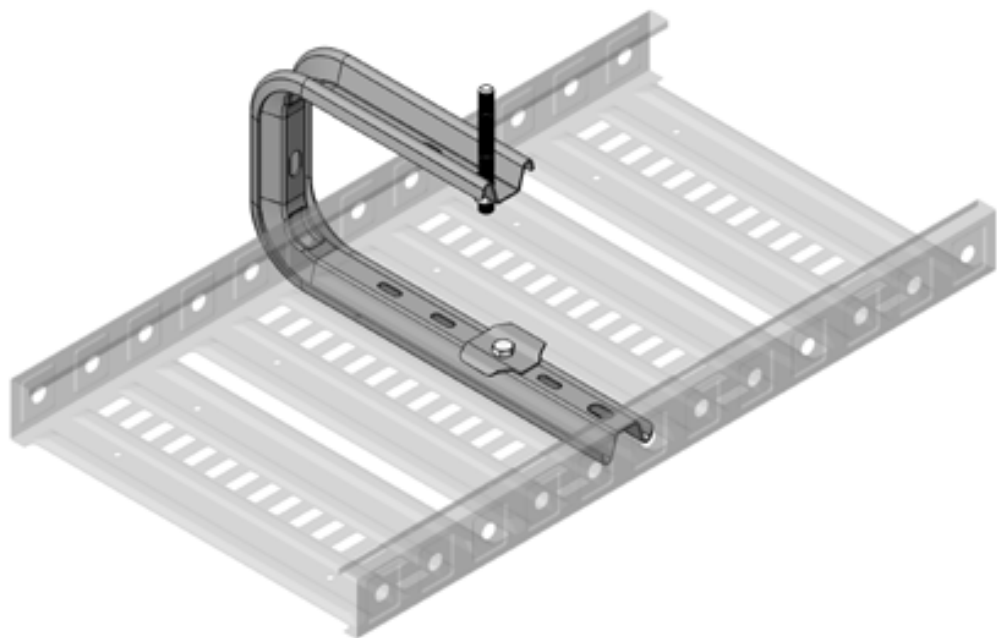

CERTIFIED QUALITY SYSTEM – ISO 9001:2015
BS OHSAS 18001 : 2007 & AS/NZS 4801:2001
PAS99 : 2012



© Mechanical Support Systems. Mechanical Support Systems reserves the right to change designs and specifications without notice.



MECHANICAL
SUPPORT
SYSTEMS
Expectations
delivered.

CANTILEVER BRACKETS - 41MM CHANNEL WIDTH SERIES

EMC1075-4

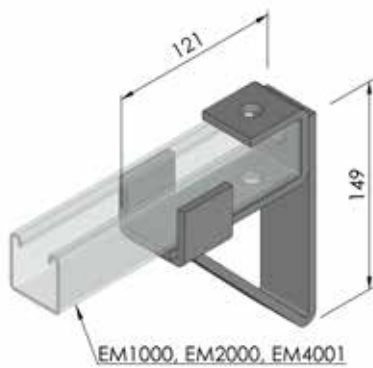

Design Load: 0.58kN*
Mass: 103kg/100
*Applies to fittings and not to strength of arm. Designe for use with nuts - do not use through bolts.

EMC1075-8

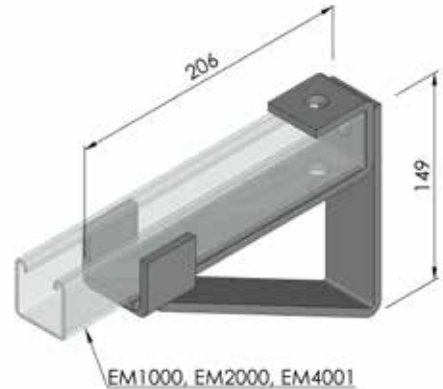

Design Lo:
Mass:
*Applies to fittings and not to strength of arm. Designe for use with nuts - do not use through bolts.

EMC2233 - 2234

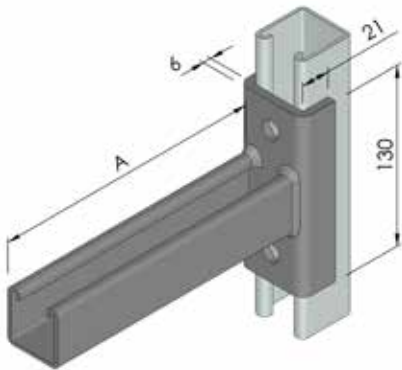

| Part No: | Load kN: | Mass kg/100: | A: |
|----------|----------|--------------|-----|
| EMC2233 | 3.14 | 189 | 457 |
| EMC2234 | 1.97 | 232 | 610 |

EMC2542 - 2546

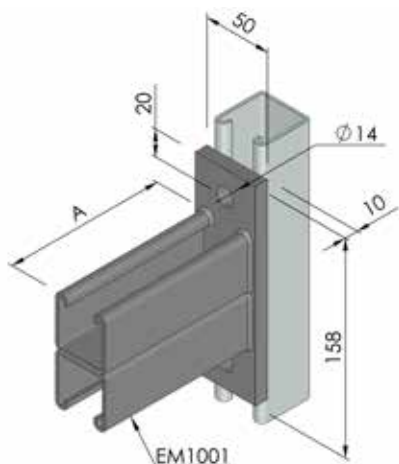

| Part No: | Load kN: | Mass kg/100: | A: |
|----------|----------|--------------|-----|
| EMC2542 | 7.57 | 228 | 305 |
| EMC2543 | 5.22 | 314 | 460 |
| EMC2544 | 3.98 | 400 | 610 |
| EMC2545 | 3.21 | 487 | 760 |
| EMC2546 | 2.67 | 574 | 915 |

General Data for Cantilever Brackets:

Standard finish HDG to AS/NZ4077 Galvanising requirements
Safety factor on all brackets = 2.5
Manufactured to ISO 9001
Load values should be calculated using AS/NZS4600 Cold-Formed Steel Structures Code

CANTILEVER BRACKETS - 41MM CHANNEL WIDTH SERIES

EMC5663-300 - 750

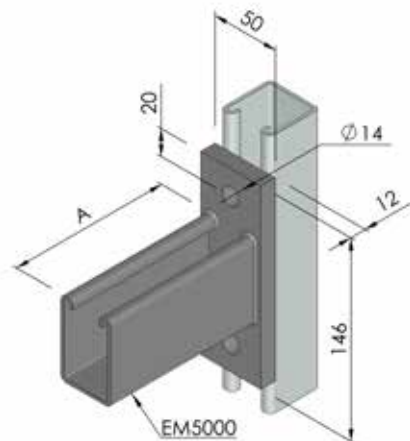

| Part No: | Load kN: | A: | Mass kg/100: |
|-------------|----------|-----|--------------|
| EMC5663-300 | 6.93 | 300 | 173 |
| EMC5663-450 | 4.78 | 450 | 224 |
| EMC5663-600 | 3.62 | 600 | 276 |
| EMC5663-750 | 2.91 | 750 | 327 |

EMC300 - 750

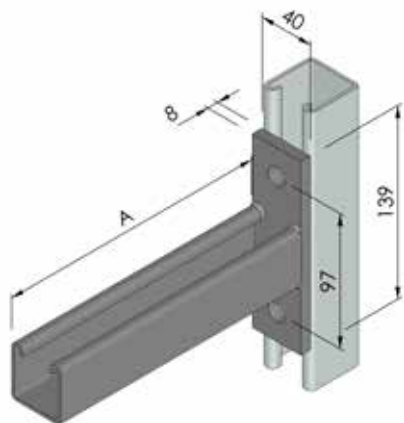

| Part No: | Load kN: | A: | Mass kg/100: |
|----------|----------|-----|--------------|
| EMC300 | 3.61 | 300 | 122 |
| EMC450 | 2.11 | 450 | 161 |
| EMC600 | 1.48 | 600 | 202 |
| EMC750 | 1.14 | 750 | 245 |

EMCB300 - 750

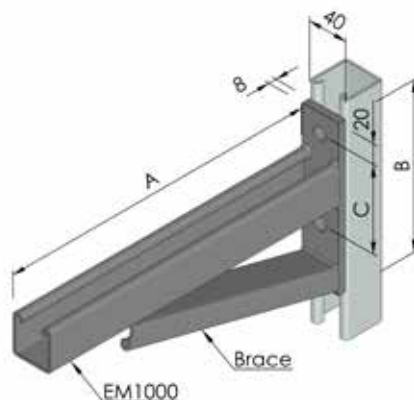

| Part No: | Load kN: | A: | B: | C: | Mass kg/100: |
|----------|----------|-----|-----|-----|--------------|
| EMCB300 | 4.47 | 320 | 165 | 86 | 170 |
| EMCB450 | 4.17 | 470 | 165 | 86 | 230 |
| EMCB600 | 3.33 | 635 | 215 | 112 | 340 |
| EMCB750 | 2.80 | 780 | 215 | 112 | 380 |

General Data for Cantilever Brackets:

Standard finish HDG to AS/NZ4077 Galvanising requirements

Safety factor on all brackets = 2.5

Manufactured to ISO 9001

Load values should be calculated using AS/NZS4600 Cold-Formed Steel Structures Code



CERTIFIED QUALITY SYSTEM – ISO 9001:2015
BS OHSAS 18001 : 2007 & AS/NZS 4801:2001
PAS99 : 2012



CABLE MESH HANGERS

VK/SIS Snap-In Support Profile

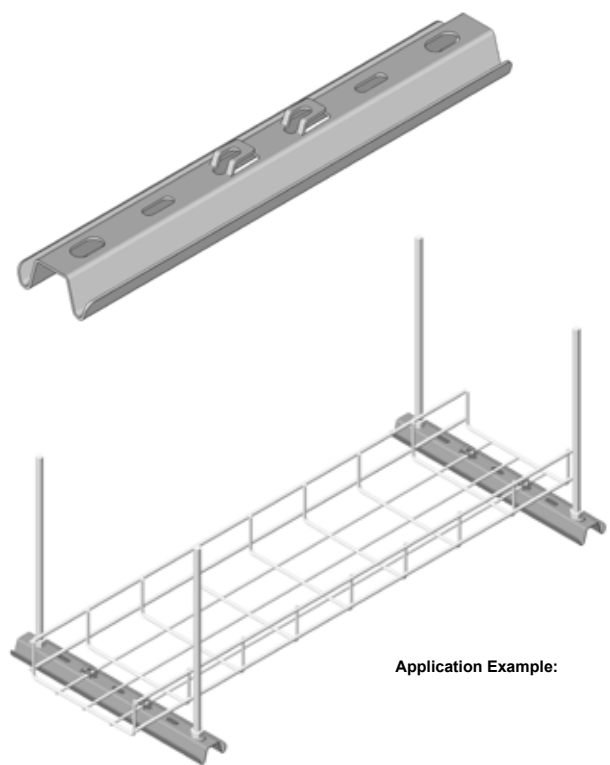
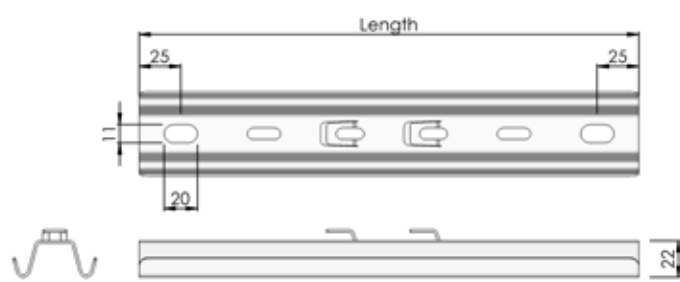

| Length: | To suit Cable Mesh width when used as floor bracket: | To suit Cable Mesh width when hanging from threaded rod: | Max. Load (kg) | Part Number: |
|---------|--|--|----------------|--------------|
| 200 | 100 | 100 | 350 | VK/SIS 200 |
| 300 | 150 | 150 | 250 | VK/SIS 300 |
| 350 | 200 | 200 | 200 | VK/SIS 350 |
| 450 | 300 | 300 | 150 | VK/SIS 450 |
| 550 | 400 | 400 | 100 | VK/SIS 550 |

Application Example:

VK/VFMM Mounting Bracket

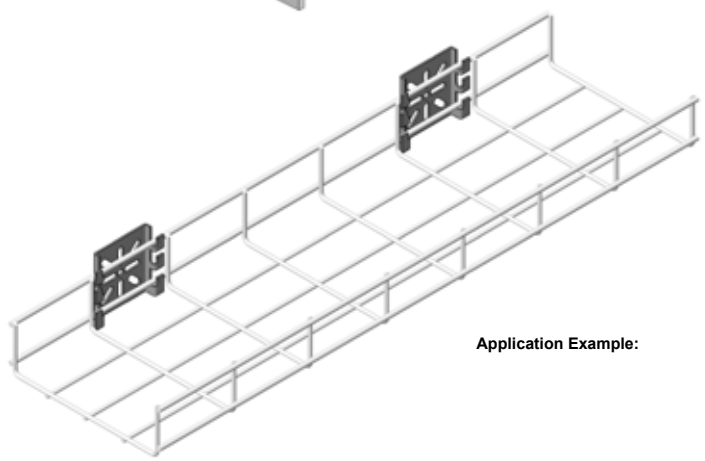
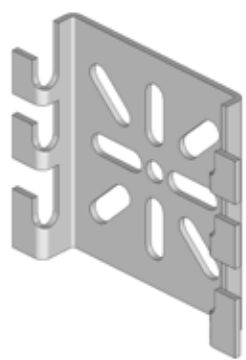
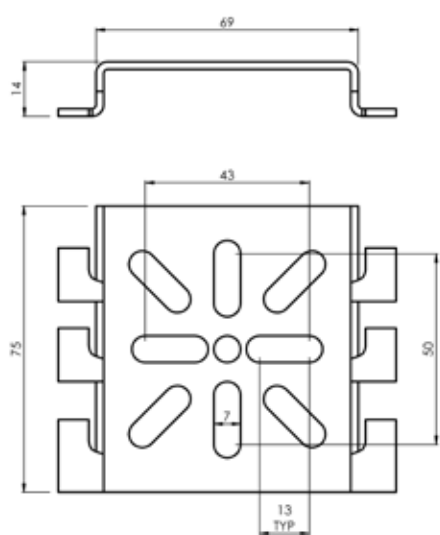

Application Example:

CERTIFIED QUALITY SYSTEM – ISO 9001:2015
BS OHSAS 18001 : 2007 & AS/NZS 4801:2001
PAS99 : 2012

CABLE MESH HANGERS

VK/VFO FOR VF Mounting Bracket

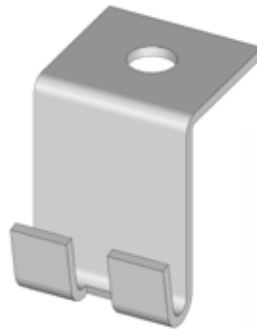
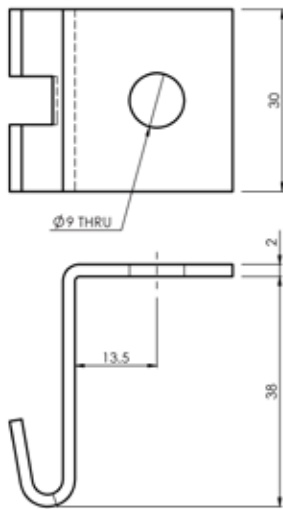

VK/VFO FOR VF Mounting Bracket
Note - this bracket is only suitable for up to 200mm wide Cable Mesh

Application Example:

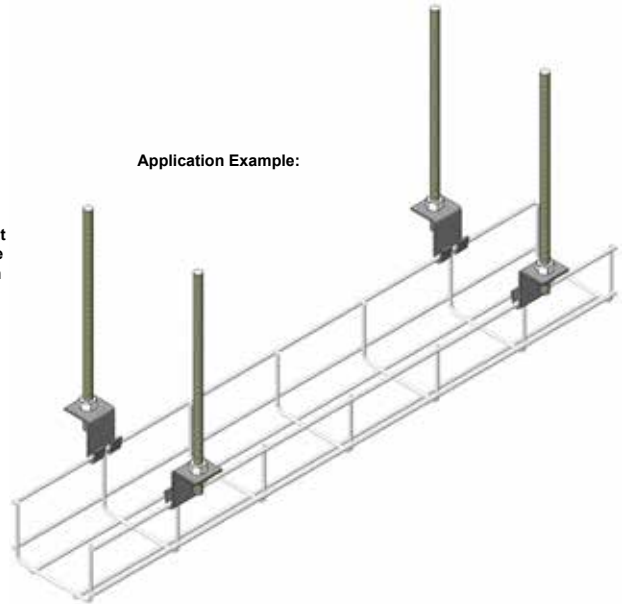

VK/VFM FOR VF Wall Bracket

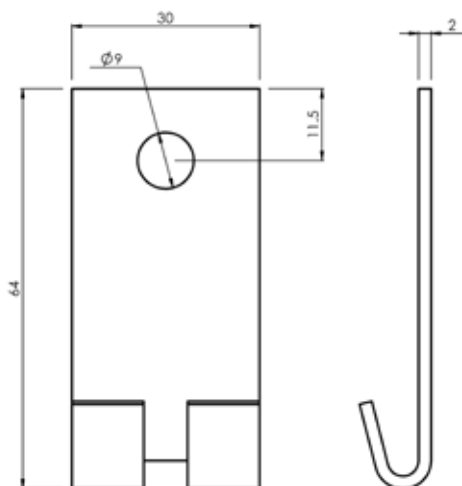

VK/VFM FOR VF Wall Bracket
Note - this bracket is only suitable for up to 200mm wide Cable Mesh

Application Example:

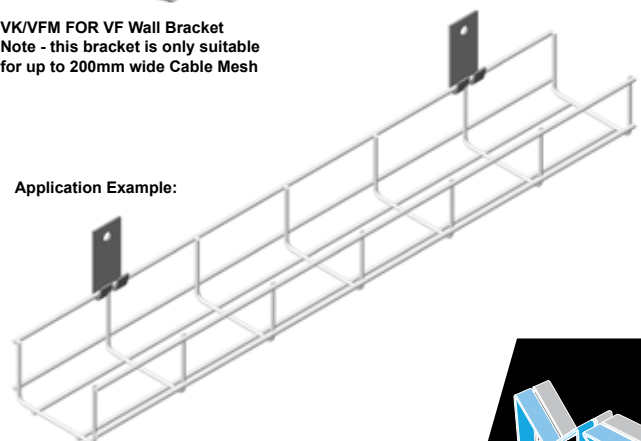

CERTIFIED QUALITY SYSTEM – ISO 9001:2015
BS OHSAS 18001 : 2007 & AS/NZS 4801:2001
PAS99 : 2012



**MECHANICAL
SUPPORT
SYSTEMS**
Expectations
delivered.

ONE-PIECE MOUNTS

VK/THB PG Single Hanger Bracket

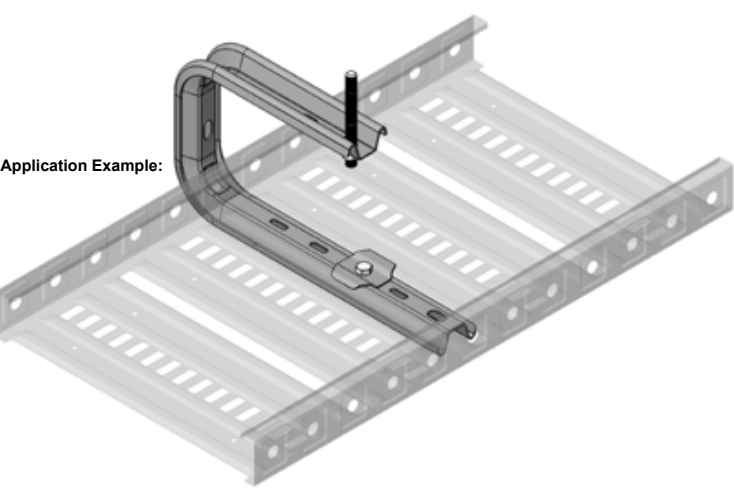
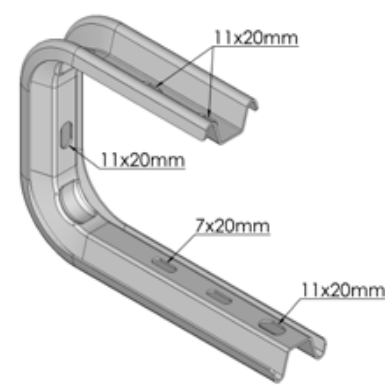
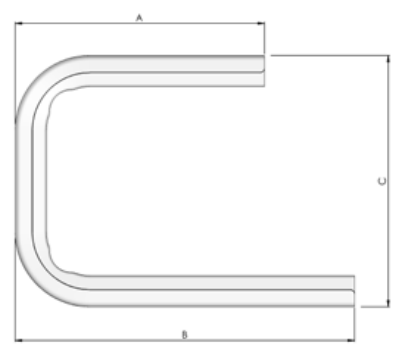

VK/THB Hanger Bracket shown clamped to Cable Tray using Hold Down Washer, suspended using Threaded Rod. The vertical section of the Hanger Bracket can be mounted to either side of the Cable Tray.

(Hold Down Washer and Threaded Rod not included)

Standard Finish: Pre-Galvanised

| Width "A": | Width "B": | Height "C": | Part Number: | Suits Cable Tray Width: |
|------------|------------|-------------|---------------|-------------------------|
| 147 | 182 | 170 | VK/THB/150 PG | 75, 100 & 150mm |
| 172 | 232 | 170 | VK/THB/200 PG | 200mm |
| 222 | 332 | 170 | VK/THB/300 PG | 300mm |

VK/WHB PG Wall Mounted Hanger Bracket

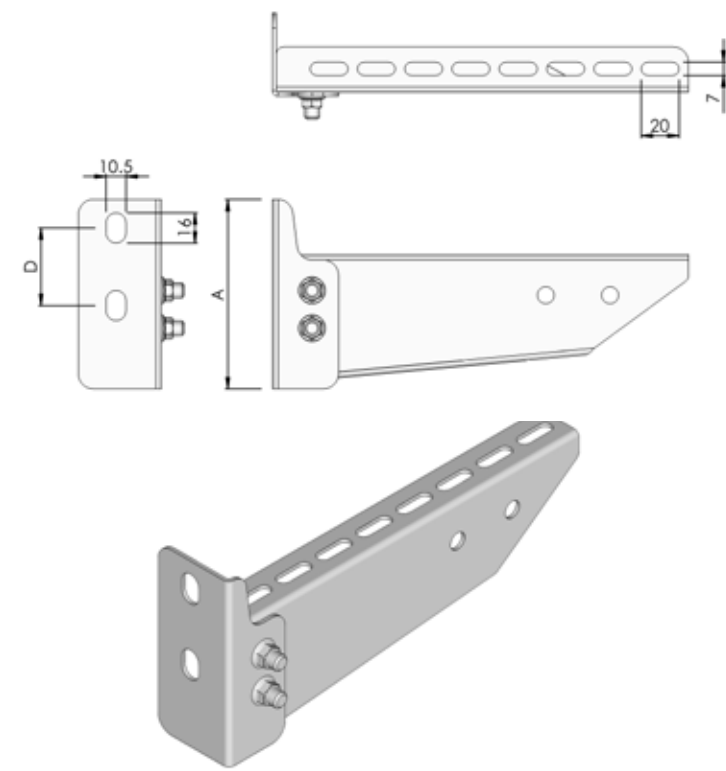

Finish: Pre-Galvanised

| Width: | Height A: | Distance D: | Maximum Load (kg): | Part Number: |
|-----------|-----------|-------------|--------------------|--------------|
| 75 or 100 | 99 | 40 | 110 | VK/WHB100 PG |
| 150 | 99 | 40 | 110 | VK/WHB150 PG |
| 200 | 99 | 40 | 120 | VK/WHB200 PG |
| 300 | 119 | 60 | 130 | VK/WHB300 PG |

CERTIFIED QUALITY SYSTEM – ISO 9001:2015
BS OHSAS 18001 : 2007 & AS/NZS 4801:2001
PAS99 : 2012

GENERAL FASTENERS AND ACCESSORIES

VK/FS PG Wall and Floor Stand

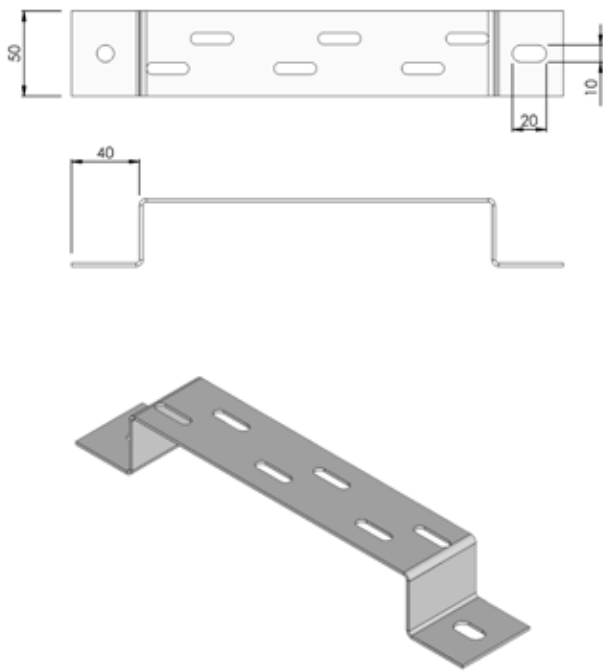

Finish: Pre-Galvanised

Maximum Load: 200 kg

Width: Part Number:

| | |
|-----------|--------------|
| 75 or 100 | VK/FS100 PG |
| 150 | VK//FS150 PG |
| 200 | VK/FS200 PG |
| 300 | VK/FS300 PG |

Wire & Accessories

| Product code: | Product Description: |
|---------------|----------------------|
| BKW094 | KWIK 2.3MM X 152M |
| EM1112 | Seismic Wire Bracket |
| BKC100 | Wire Clamps |



CERTIFIED QUALITY SYSTEM – ISO 9001:2015
BS OHSAS 18001 : 2007 & AS/NZS 4801:2001
PAS99 : 2012



Fast Locking Clip



| Product Code: | Locking clip use: | Finish: |
|---------------|----------------------------------|---------|
| KBSI/KBV | KBSI Tray & Accessories/Trunking | 316 S/S |

Flanged Bolt & Nut



| Product Code: | Finish: |
|---------------|----------|
| EMT/TB Bolt | ZP / HDG |
| EMT/TN Nut | ZP / HDG |

Rod Cutting Tools



VK/VF Wire Bolt Cutter



VK/VF WIRE BOLT CUTTER
Powerbuilt 14" wire bolt cutters,
recommended for cutting Cable Mesh

| Part No: | Description: |
|----------------|---------------------------------------|
| EMTHRRODCUTTER | Threaded rod cutter |
| EMRODBLADEM06 | Threaded rod cutter blade for M6 rod |
| EMRODBLADEM08 | Threaded rod cutter blade for M8 rod |
| EMRODBLADEM10 | Threaded rod cutter blade for M10 rod |

Cutting and Grinding Discs

| Size: | Description: |
|------------|-------------------|
| 115X1.0X22 | CUT OFF WHEEL |
| 115X6.0X22 | 80 GRIT FLAP DISC |
| 125X1.0X22 | CUT OFF WHEEL |
| 125X6.0X22 | 80 GRIT FLAP DISC |



Coating Spray Can

| Description: |
|--------------------|
| SPRAY - EPC COLOUR |
| SPRAY - ZINC GALV |



CERTIFIED QUALITY SYSTEM – ISO 9001:2015
BS OHSAS 18001 : 2007 & AS/NZS 4801:2001
PAS99 : 2012

Product Catalogue Range

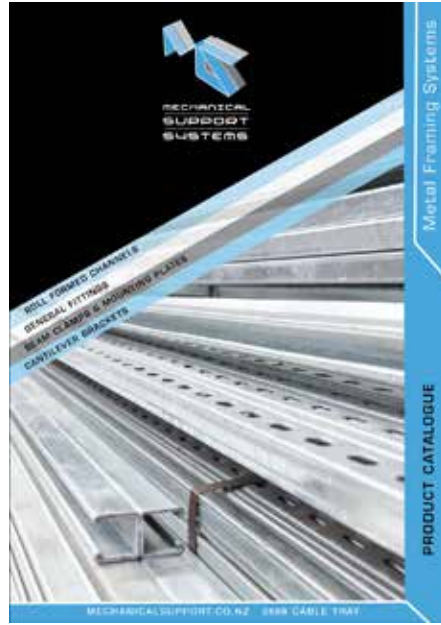
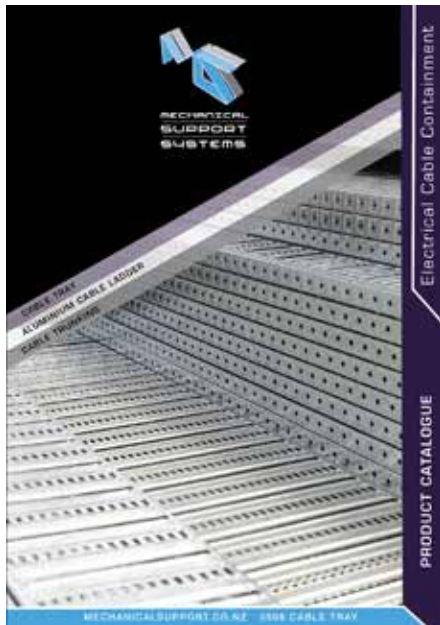

Download a catalogue www.mechanicalsupport.co.nz

Get in touch with us **0508 CABLE TRAY** or (09) 279-8292

CERTIFIED QUALITY SYSTEM – ISO 9001:2015
BS OHSAS 18001 : 2007 & AS/NZS 4801:2001
PAS99 : 2012





MECHANICALSUPPORT.CO.NZ
0508 CABLE TRAY (0508 222 5387)

© Mechanical Support Systems. Mechanical Support Systems reserves the right to change designs and specifications without notice.



**MECHANICAL
SUPPORT
SYSTEMS**
Expectations
delivered.